

COLD BOX

The complete package of brazed aluminum heat exchanger and piping assembly with perlite insulation

TECHNICAL FEATURES

SPP's cold box can minimize the installation space at commissioning site by providing the complete unit package of heat exchanger and piping assembly.

Cold box can be easily installed and easy access to the connection piping will reduce the installation work of pre-commissioning at site.

Insulation work of heat exchanger and piping assembly can be easily done by perlite insulation.

Inside of cold box will be pressurized and purged by dry nitrogen gas.

Nitrogen Purge System

(*) not shown in the sketch

- Purge inlet nozzle
- Purge Line inside cold box
- Breather Valve on the roof
- Emergency Hatch on the Roof(*)
- Sampling nozzles (*)
- Low Pressure Gauge (*)

Other Accessories

- Anchor Bolt Set
- Platform and Ladder
- Drain / Vent Lines
- Instrument Lines
- Instruments (Thermocouple, Valve, Orifice, etc)

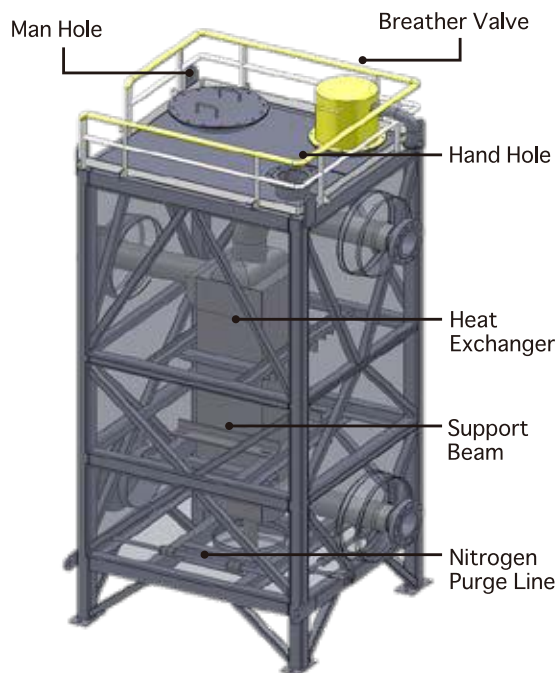

SPP Cold Boxes were installed at Japan, South Korea, United States, Canada, Indonesia, Singapore and many other international countries. SPP have provided more than 120 cold boxes in the past.

Example of Complete Package Design

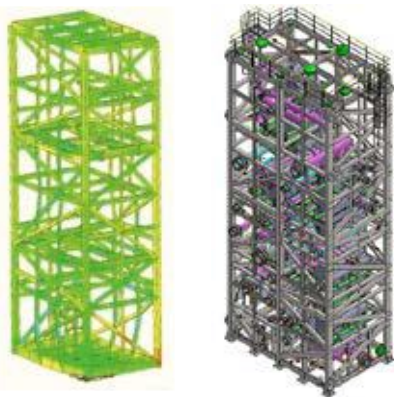

Structural Analysis and Seismic Design will be performed at basic design of steel structure frame.

Cold box will be used for following process:

- Natural Gas Liquefaction
- Methane Production
- Ethylene Production
- Ethylene Recovery Unit
- BOG Condenser
- LNG Cold Utilization

The following pictures are the reference of cold boxes for cryogenic industry



7.0m x 7.5m x 19.0m, 210ton



6.0m x 6.35m x 17.5m, 127ton



5.4m x 3.4m x 14.5m, 60ton

Sumitomo Precision Products Co., Ltd.

Heat exchangers Sales & Marketing Department
Sumitomo Corporation Takebashi Bldg 4th floor,
1-2-2 Hitotsubashi, Chiyoda-ku, Tokyo 100-0003, Japan

+81-3-3217-2812

WEB <http://www.spp.co.jp/netsu/en/>
FAX +81-3-3217-2822 E-mail netu-sales@spp.co.jp